



Healthier Kids. Healthier Future.

# Welcome

## To the Murdoch Childrens Research Institute

### Arriving by Car

The Murdoch Childrens Research Institute (MCRI) is in the Royal Children's Hospital (RCH) located on Flemington Road in Parkville, Melbourne.

### Parking

Enter from Entry 1 or Entry 2 on Flemington Road. To gain entry, take a ticket from the ticket box at the boom gate and the gate will open. There are three levels of parking - B1, B2 and B3. Indicator boards will tell drivers when a level is full or how many vacant spots are available on each level. The car park will be open 24 hours a day, seven days a week.

### Public Transport

Trams 59 and 55 stop outside the main entrance to the Hospital at Stop 19, Flemington Road. Public transport tickets can be purchased from the retail pharmacy in Main Street.

### Dropping Off

There are two drop-off zones. One is located at the main entrance and the other is out the front of Emergency.

### Entry to MCRI

Enter via the MCRI Revolving Door at the front entrance of the Hospital, this is next to the Hospital Entry Revolving Door. Please sign in at the MCRI Reception, Ground Floor, and you will be provided a Visitors Card and directions on how to proceed to your destination.

### Payment and Exit

Payment must be made at one of the car park payment machines before you return to your car. Pay stations are located at:

- Main Street, Ground Floor (Beach)
- Emergency, Lower Ground (Underwater)
- Yellow lift lobby, Basement 1 (Underground)
- Yellow lift lobby, Basement 2
- Yellow lift lobby, Basement 3

The car park exit takes you on to Flemington Road. Exit 1 is left hand turn only. Exit 2 is left or right hand turn.

Healthier Kids. Healthier Future.

# Welcome

## To the Murdoch Childrens Research Institute

Ground floor

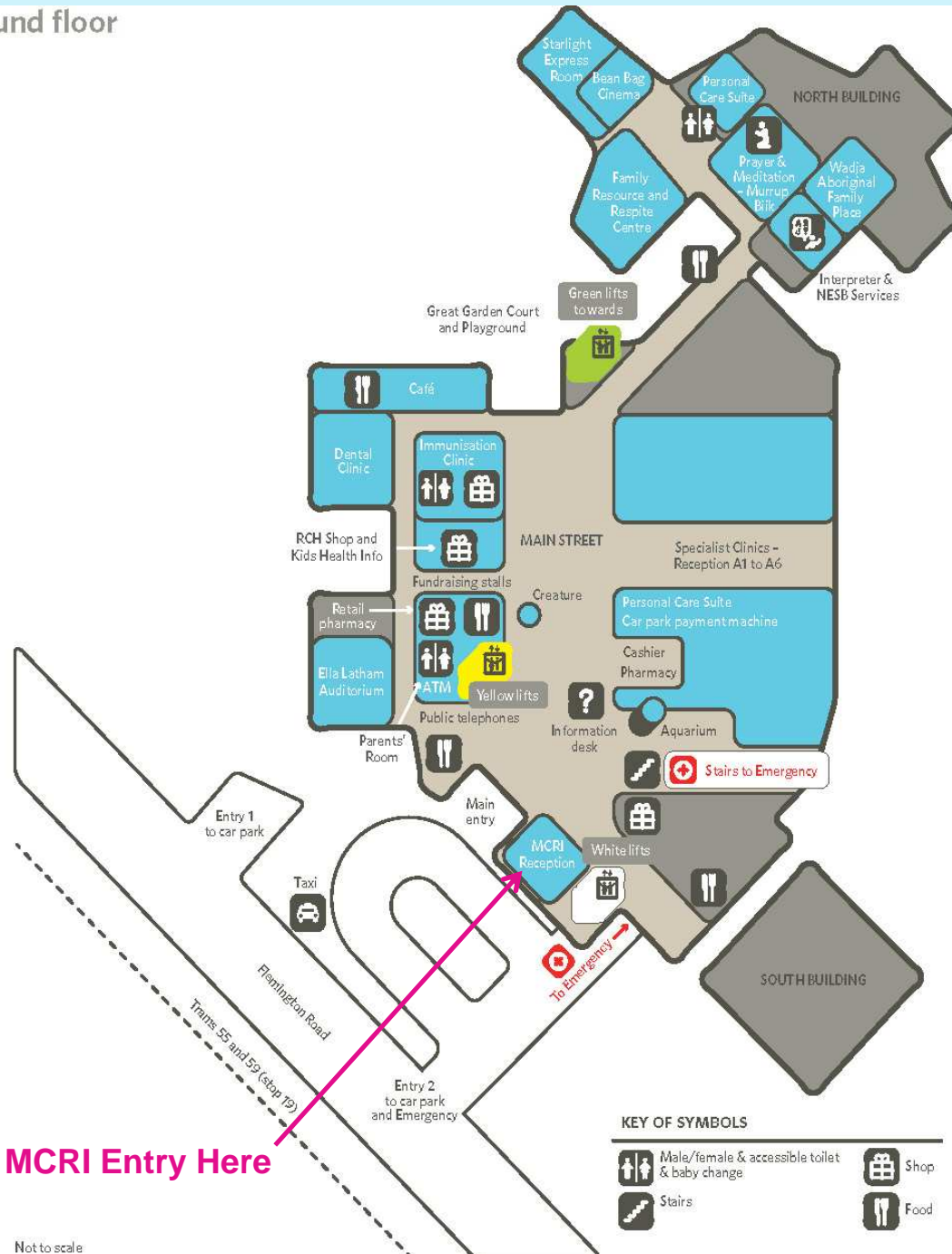

Healthier Kids. Healthier Future.

# Welcome

To the Murdoch Childrens Research Institute,  
Royal Children's Hospital, Flemington Road, Parkville VIC 3052

